

Case Study: Semiconductor Assembly & Test

- **Purpose/Scope:**

- Visualize and Measure current material flow
- Recommend relayout changes to smooth flow & reduce distance traveled

- **Results:**

- In 1 week:

- Material flow for the top 9 products were documented, modeled, and analyzed.
- 3 relayout changes were created.
- New layout reduced annual flow by **2.8 million meters / 3.1 million yards**

BEFORE

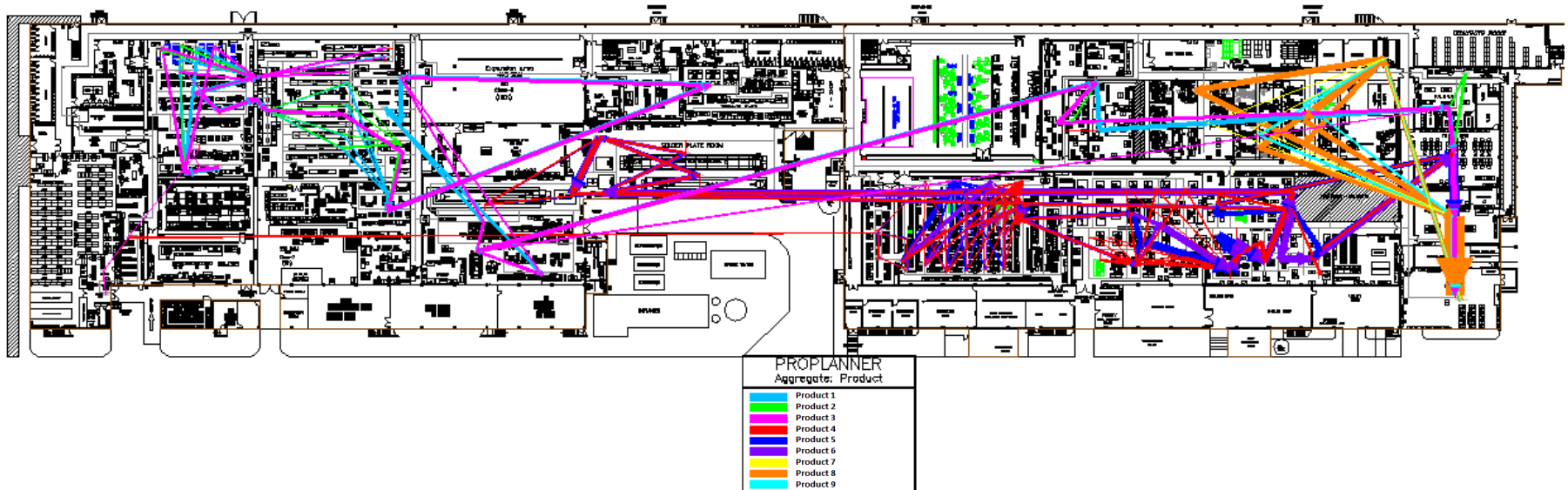

Case Study: Semiconductor Assembly & Test

BEFORE

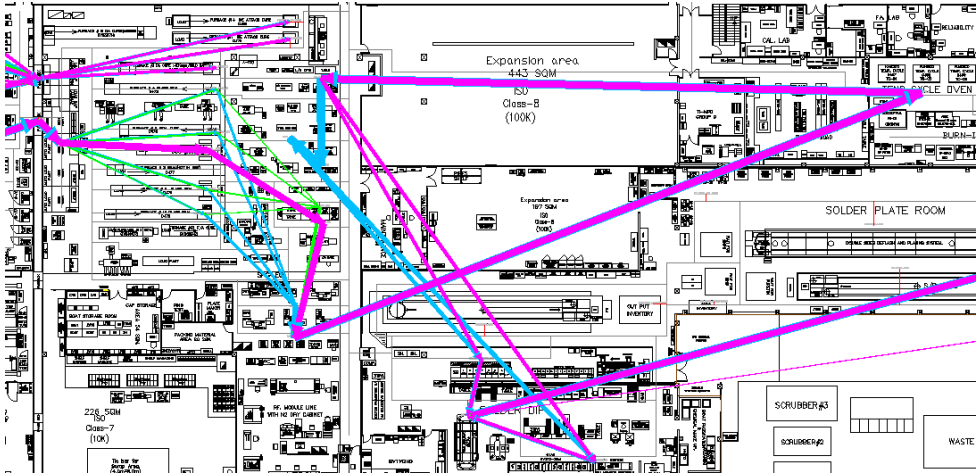

AFTER

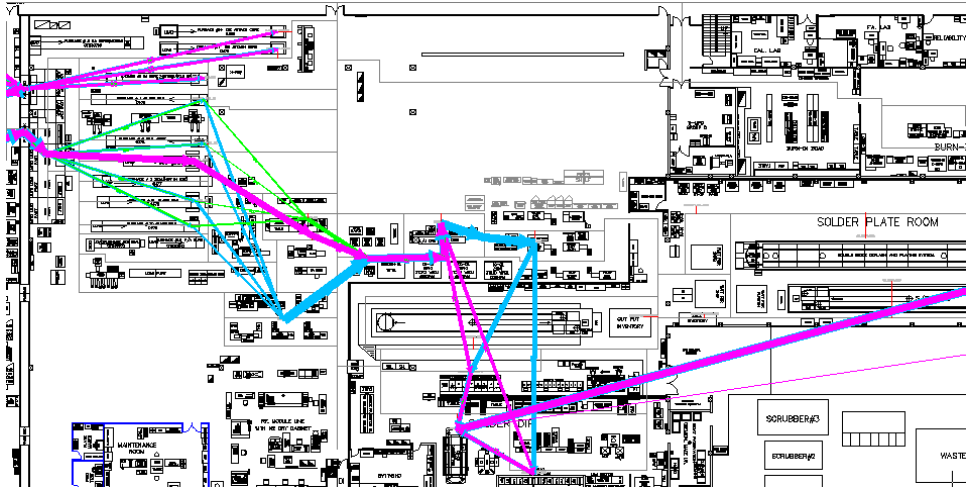

Case Study: Semiconductor Assembly & Test

BEFORE

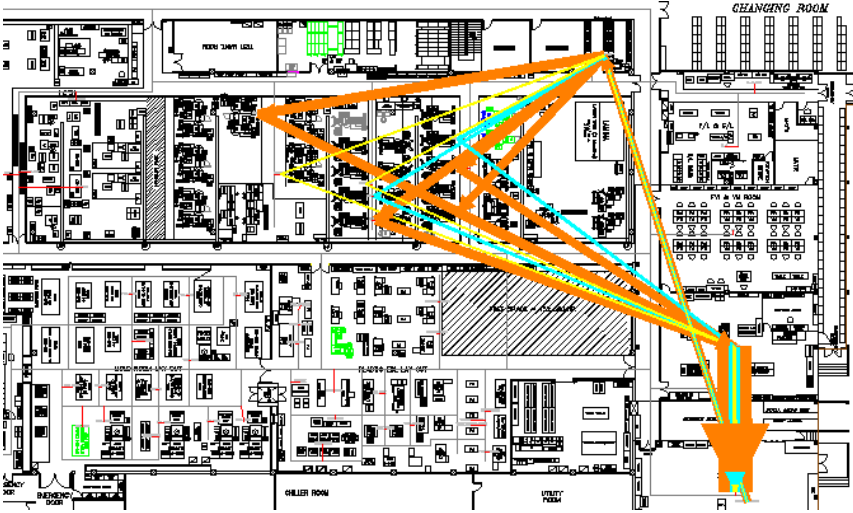

AFTER



Case Study: Semiconductor Assembly & Test

BEFORE

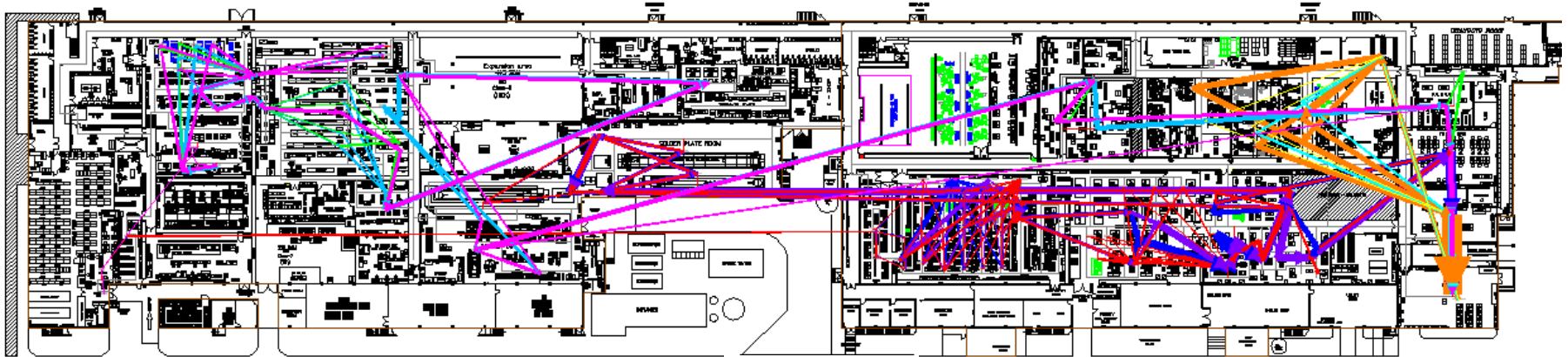

AFTER



1 week of modern industrial engineering analysis = 2.8 million meters / 3.1 million yards saved per year